

# Tridonic TALEXXconverter LC 45W 500-1400mA flexC SR EXC

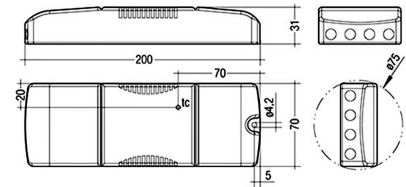

## Technical Details:

Input Current:	AC 198 - 264V, 230mA, 50/60Hz, DC 176 - 280V
Power Consumption:	52 W
Driver Manufacturer:	Tridonic
Power Factor (PF):	>0.95
Input Driver:	terminal
Output of Driver:	DC 20-50V, 500-1400mA
CC/CV:	CC
Output Current Adjustable:	✓
Switching Cycles:	>100.000
Electrical Protection Class:	II
Compatible with Emergency Current:	✓
Loop-Through Cabling:	✓
Ambient Temperature (TA):	-25°C - 50°C

Dimensions:	200x70x31 mm
IP Class:	20
Housing Color	white
Housing Material:	Polycarbonat
Special Feature of Housing:	Through-wiring
Net Weight:	215 g
Type of Packaging:	box
Content Master Package:	10
Warranty	5 years
Operating Hours:	100.000 h
Disposal Obligation:	✓
Customs Tariff Number:	8504408390
Certifications	CE,ENEC,SELV
Barcode:	9006210525815
Ausgangsstromanpassung über Widerstandsplug	

Information and Downloads:

